

DIVERSITY HOMES



4003 Clairmont Rd. (Bismarck)

\$529,900

- 2127 Square Feet (Slab On Grade)
- Open Floor Plan with an Extra Family Room and Abundance of Storage
- Grand Entry with 15' High Ceilings!! Additional Raised Ceiling Insets throughout Main Living Area and Master Bedroom
- 3 Bedrooms, 2 Baths
- Master Suite W/ Soaker Tub, Tiled Shower and Walk-In Closet
- Kitchen Includes Maple Cabinets, Double Oven, Large Island, and Quartz Countertops
- Gas Fireplace with Detail
- Oversized, 3 Stall Garage with Hot/Cold, and Floor Drain
- Covered Patio

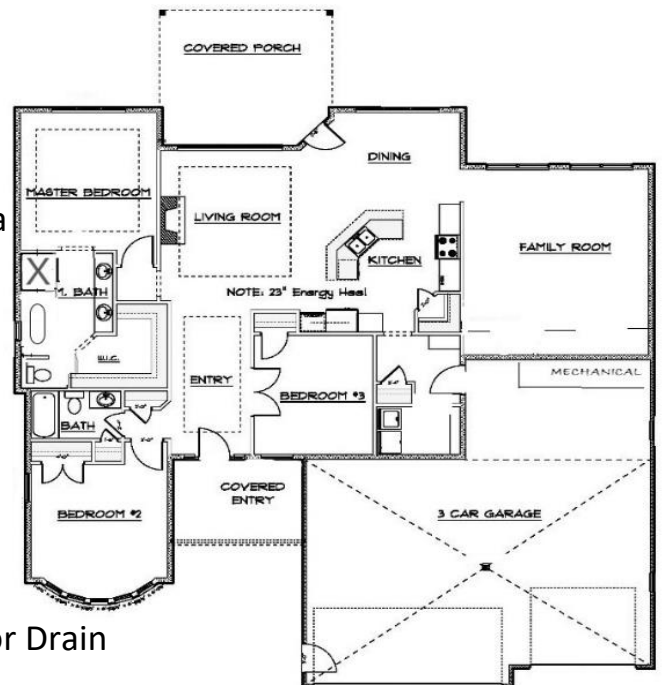

Contact:

Stephanie Metzger: 701-220-4490

Shawnee Muller: 701-202-0694

Office: 701-751-3999