

DIVERSITY HOMES

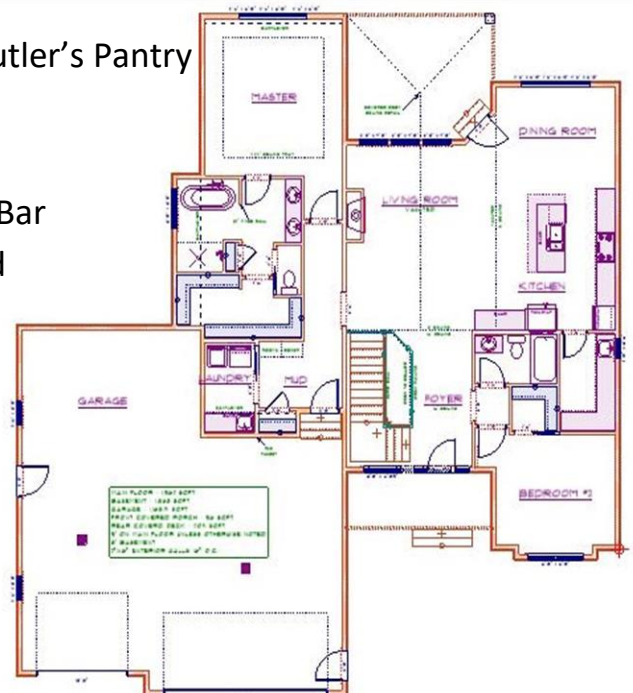

3925 Herd Place (Bismarck) 679,900

- 3730 Sf of Finished Living Space
- Open Floor Plan with a Grand 16ft High Foyer and Vaulted Ceilings throughout Main Living Area
- Featuring 5 Bedrooms, 3 Baths
- Master Suite Includes Custom Tiled Shower, Soaker tub, and Oversized Walk-In Closet
- Kitchen has a Double Oven and Huge Walk –In Butler’s Pantry
- Quartz Countertops Throughout
- Diversity Signature Railing with Open Staircase
- Walk out Basement with Theater Room and Wet Bar
- 1,312 Sf Oversized, Heated Garage with Hot/Cold and Floor Drain
- Covered Maintenance Free Deck



Contact:

Stephanie Metzger 701-220-4490

Shawnee Muller 701-202-0694

Office 701-751-3999